



# HCH HCT

**Extremely robust wall-mounted or tubular axial fans**



HCH



HCT

Axial or tubular wall-mounted fans, PL version fitted with a plastic impeller and AL version with an aluminium impeller.

**Fan:**

- Airflow direction from motor to impeller.
- PL version in fibreglass-reinforced polyamide-6 rots and AL version in cast aluminium. Models 40-2T and HCT-45-2T only in AL version.
- HCH: Sheet steel metal support ring.
- HCT: Tubular casing in sheet steel with external terminal box.

**Motor:**

- IE3 efficiency motors for powers equal to or higher than 0.75kW except single-phase, 2-speed and 8-pole.
- Class F motors with ball bearings, IP55 protection, except single-phase models from size 45 to size 56, IP54 protection. 1 or 2 speeds, depending on model.

- Single-phase 230V-50Hz and three-phase 230/400V-50Hz (up to 4kW) and 400/690V-50Hz (powers higher than 4kW).
- Operating temperature: -25°C+ 50°C.

**Finish:**

- Anti-corrosive finish of polyester resin polymerised at 190°C, previously degreased with phosphate-free nanotechnological treatment.

**On request:**

- Airflow direction from impeller to motor.
- 100% reversible impellers.
- Special windings for different voltages.
- ATEX-certified Category 2.



**Order code**

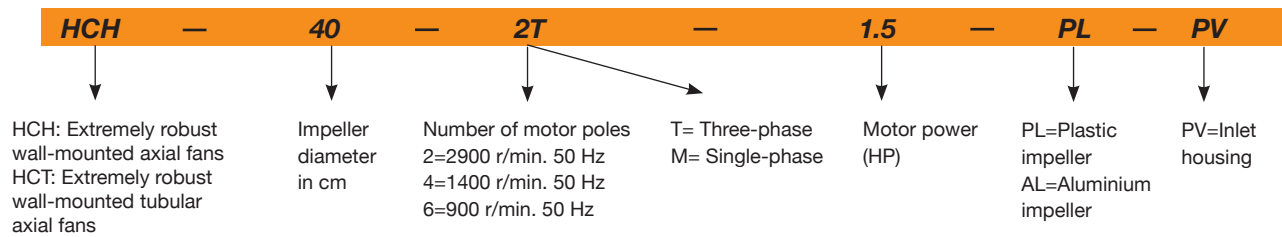

**Technical characteristics**

| Model                 | Speed (r/min) | Max. admissible current (A) |       |       | Installed power (kW) | Maximum flow rate (m³/h) | Sound pressure level dB(A) | Approx. weight (kg) |     | According to ErP |          |
|-----------------------|---------------|-----------------------------|-------|-------|----------------------|--------------------------|----------------------------|---------------------|-----|------------------|----------|
|                       |               | 230 V                       | 400 V | 690 V |                      |                          |                            | HCH                 | HCT | HCH              | HCT      |
| - HCT 25-2T           | 2670          | 0.64                        | 0.37  |       | 0.09                 | 1950                     | 64                         | -                   | 7   | -                | 2015     |
| - HCT 25-2M           | 2760          | 0.79                        |       |       | 0.09                 | 1950                     | 64                         | -                   | 7   | -                | *        |
| - HCT 25-4T           | 1320          | 0.65                        | 0.38  |       | 0.09                 | 1000                     | 50                         | -                   | 7   | -                | Excluded |
| - HCT 25-4M           | 1380          | 0.65                        |       |       | 0.10                 | 1000                     | 50                         | -                   | 7   | -                | Excluded |
| - HCT 31-2T           | 2750          | 1.21                        | 0.7   |       | 0.18                 | 2900                     | 70                         | -                   | 8   | -                | 2015     |
| - HCT 31-2M           | 2780          | 1.42                        |       |       | 0.18                 | 2900                     | 70                         | -                   | 8   | -                | *        |
| - HCT 31-4T           | 1320          | 0.65                        | 0.38  |       | 0.09                 | 1550                     | 52                         | -                   | 8   | -                | Excluded |
| - HCT 31-4M           | 1380          | 0.65                        |       |       | 0.10                 | 1550                     | 52                         | -                   | 8   | -                | Excluded |
| HCH HCT 35-2T         | 2710          | 1.92                        | 1.11  |       | 0.37                 | 5750                     | 77                         | 9                   | 12  | 2015             | 2015     |
| - HCT 35-2M           | 2780          | 2.53                        |       |       | 0.37                 | 5750                     | 77                         | -                   | 12  | -                | 2015     |
| HCH HCT 35-4T         | 1320          | 0.65                        | 0.38  |       | 0.09                 | 3100                     | 59                         | 7                   | 10  | 2015             | 2015     |
| - HCT 35-4M           | 1380          | 0.65                        |       |       | 0.10                 | 3100                     | 59                         | -                   | 10  | -                | 2015     |
| HCH HCT 40-2T-1.5 IE3 | 2830          | 4.03                        | 2.34  |       | 1.10                 | 8800                     | 84                         | 18                  | 26  | 2015             | 2015     |
| HCH HCT 40-4T-0.33    | 1350          | 1.66                        | 0.96  |       | 0.25                 | 5150                     | 64                         | 13                  | 21  | 2015             | 2015     |
| - HCT 45-2T-2 IE3     | 2875          | 5.34                        | 3.07  |       | 1.50                 | 10650                    | 86                         | -                   | 35  | -                | 2015     |
| - HCT 45-2T-3 IE3     | 2910          | 7.32                        | 4.21  |       | 2.20                 | 12750                    | 88                         | -                   | 39  | -                | 2015     |

## Technical characteristics

| Model                  | Speed<br>(r/min) | Max. admissible current<br>(A) |       |       | Installed<br>power<br>(kW) | Maximum<br>flow rate<br>(m <sup>3</sup> /h) | Sound<br>pressure level<br>dB(A) | Approx.<br>weight (kg) |     | According<br>to ErP |      |
|------------------------|------------------|--------------------------------|-------|-------|----------------------------|---|----------------------------------|------------------------|-----|---------------------|------|
|                        |                  | 230 V                          | 400 V | 690 V |                            |   |                                  | HCH                    | HCT | HCH                 | HCT  |
| HCH HCT 45-4T-0.5      | 1370             | 2.02                           | 1.17  |       | 0.37                       | 7100  | 68                               | 15                     | 24  | 2015                | 2015 |
| HCH HCT 45-4M-0.5      | 1400             | 2.76                           |       |       | 0.37                       | 7100  | 68                               | 15                     | 24  | 2015                | 2015 |
| HCH - 45-6T-0.33       | 900              | 1.51                           | 0.87  |       | 0.25                       | 4750  | 55                               | 14                     | -   | 2015                | -    |
| - HCT 50-4T-0.75       | 1380             | 2.92                           | 1.69  |       | 0.55                       | 10400                                       | 70                               | -                      | 28  | -                   | 2015 |
| HCH HCT 56-4T-0.75     | 1380             | 2.92                           | 1.69  |       | 0.55                       | 11050                                       | 72                               | 21                     | 33  | 2015                | 2015 |
| HCH HCT 56-4T-1 IE3    | 1420             | 2.82                           | 1.62  |       | 0.75                       | 12950                                       | 73                               | 23                     | 35  | 2015                | 2015 |
| HCH HCT 56-4T-1.5 IE3  | 1455             | 4.07                           | 2.34  |       | 1.10                       | 14000                                       | 74                               | 30                     | 41  | 2015                | 2015 |
| HCH HCT 56-4T-2 IE3    | 1440             | 5.41                           | 3.11  |       | 1.50                       | 15300                                       | 75                               | 36                     | 47  | 2015                | 2015 |
| HCH HCT 56-6T-0.33     | 900              | 1.51                           | 0.87  |       | 0.25                       | 8500  | 61                               | 18                     | 30  | 2015                | 2015 |
| HCH HCT 56-6T-0.5      | 900              | 2.24                           | 1.30  |       | 0.37                       | 9300  | 61                               | 20                     | 32  | 2015                | 2015 |
| HCH HCT 56-6T-0.75     | 900              | 2.99                           | 1.73  |       | 0.55                       | 10000                                       | 62                               | 22                     | 34  | 2015                | 2015 |
| HCH HCT 63-4T-1 IE3    | 1420             | 2.82                           | 1.62  |       | 0.75                       | 14150                                       | 73                               | 28                     | 43  | 2015                | 2015 |
| HCH HCT 63-4T-1.5 IE3  | 1455             | 4.07                           | 2.34  |       | 1.10                       | 17000                                       | 74                               | 34                     | 49  | 2015                | 2015 |
| HCH HCT 63-4T-2 IE3    | 1440             | 5.41                           | 3.11  |       | 1.50                       | 18900                                       | 75                               | 41                     | 56  | 2015                | 2015 |
| HCH HCT 63-4T-3 IE3    | 1435             | 7.93                           | 4.56  |       | 2.20                       | 22100                                       | 76                               | 42                     | 58  | 2015                | 2015 |
| HCH HCT 63-4T-4 IE3    | 1440             | 10.70                          | 6.15  |       | 3.00                       | 25400                                       | 77                               | 48                     | 64  | 2015                | 2015 |
| HCH HCT 63-6T-0.5      | 900              | 2.24                           | 1.30  |       | 0.37                       | 12150                                       | 64                               | 25                     | 40  | 2015                | 2015 |
| HCH HCT 63-6T-0.75     | 900              | 2.99                           | 1.73  |       | 0.55                       | 12750                                       | 65                               | 27                     | 42  | 2015                | 2015 |
| HCH HCT 63-6T-1 IE3    | 940              | 3.36                           | 1.93  |       | 0.75                       | 13800                                       | 66                               | 36                     | 51  | *                   | *    |
| HCH HCT 71-4T-1.5 IE3  | 1455             | 4.07                           | 2.34  |       | 1.10                       | 19750                                       | 78                               | 37                     | 56  | 2015                | 2015 |
| HCH HCT 71-4T-2 IE3    | 1440             | 5.41                           | 3.11  |       | 1.50                       | 21100                                       | 79                               | 44                     | 63  | 2015                | 2015 |
| HCH HCT 71-4T-3 IE3    | 1435             | 7.93                           | 4.56  |       | 2.20                       | 23950                                       | 81                               | 46                     | 65  | 2015                | 2015 |
| HCH HCT 71-4T-4 IE3    | 1440             | 10.70                          | 6.15  |       | 3.00                       | 29400                                       | 82                               | 52                     | 71  | 2015                | 2015 |
| HCH HCT 71-6T-0.75     | 900              | 2.99                           | 1.73  |       | 0.55                       | 15150                                       | 67                               | 29                     | 49  | 2015                | 2015 |
| HCH HCT 71-6T-1 IE3    | 940              | 3.36                           | 1.93  |       | 0.75                       | 17250                                       | 68                               | 39                     | 58  | 2015                | 2015 |
| HCH HCT 71-6T-1.5 IE3  | 945              | 4.68                           | 2.69  |       | 1.10                       | 20950                                       | 69                               | 44                     | 63  | 2015                | 2015 |
| HCH HCT 80-4T-3 IE3    | 1435             | 7.93                           | 4.56  |       | 2.20                       | 28000                                       | 82                               | 54                     | 73  | 2015                | 2015 |
| HCH HCT 80-4T-4 IE3    | 1440             | 10.70                          | 6.15  |       | 3.00                       | 32700                                       | 83                               | 60                     | 79  | 2015                | 2015 |
| HCH HCT 80-4T-5.5 IE3  | 1450             | 13.90                          | 8.00  |       | 4.00                       | 37200                                       | 84                               | 62                     | 81  | 2015                | 2015 |
| HCH HCT 80-6T-1 IE3    | 940              | 3.36                           | 1.93  |       | 0.75                       | 20600                                       | 71                               | 47                     | 67  | 2015                | 2015 |
| HCH HCT 80-6T-1.5 IE3  | 945              | 4.68                           | 2.69  |       | 1.10                       | 24250                                       | 72                               | 52                     | 72  | 2015                | 2015 |
| HCH HCT 80-6T-2 IE3    | 950              | 6.43                           | 3.70  |       | 1.50                       | 28000                                       | 73                               | 56                     | 75  | 2015                | 2015 |
| HCH HCT 80-6T-3 IE3    | 950              | 9.08                           | 5.22  |       | 2.20                       | 32500                                       | 74                               | 61                     | 80  | 2015                | 2015 |
| HCH HCT 90-4T-4 IE3    | 1440             | 10.70                          | 6.15  |       | 3.00                       | 37750                                       | 87                               | 67                     | 95  | 2015                | 2015 |
| HCH HCT 90-4T-5.5 IE3  | 1450             | 13.90                          | 8.00  |       | 4.00                       | 41850                                       | 89                               | 69                     | 97  | 2015                | 2015 |
| HCH HCT 90-4T-7.5 IE3  | 1465             |                                | 10.30 | 5.97  | 5.50                       | 47000                                       | 91                               | 106                    | 132 | 2015                | 2015 |
| HCH HCT 90-4T-10 IE3   | 1465             |                                | 13.90 | 8.06  | 7.50                       | 53000                                       | 92                               | 110                    | 136 | 2015                | 2015 |
| HCH HCT 90-6T-3 IE3    | 950              | 9.08                           | 5.22  |       | 2.20                       | 35000                                       | 78                               | 68                     | 96  | 2015                | 2015 |
| HCH HCT 90-6T-4 IE3    | 970              | 12.00                          | 6.91  |       | 3.00                       | 40000                                       | 79                               | 88                     | 114 | 2015                | 2015 |
| HCH HCT 100-4T-7.5 IE3 | 1465             |                                | 10.30 | 5.97  | 5.50                       | 52500                                       | 92                               | 114                    | 144 | 2015                | 2015 |
| HCH HCT 100-4T-10 IE3  | 1465             |                                | 13.90 | 8.06  | 7.50                       | 58500                                       | 93                               | 118                    | 147 | 2015                | 2015 |
| HCH HCT 100-4T-15 IE3  | 1470             |                                | 20.90 | 12.10 | 11.00                      | 68000                                       | 94                               | 150                    | 185 | 2015                | 2015 |
| HCH HCT 100-4T-20 IE3  | 1465             |                                | 27.90 | 16.20 | 15.00                      | 71850                                       | 95                               | 161                    | 196 | 2015                | 2015 |
| HCH HCT 100-6T-3 IE3   | 950              | 9.08                           | 5.22  |       | 2.20                       | 40500                                       | 82                               | 76                     | 107 | 2015                | 2015 |
| HCH HCT 100-6T-4 IE3   | 970              | 12.00                          | 6.91  |       | 3.00                       | 46950                                       | 83                               | 96                     | 125 | 2015                | 2015 |
| HCH HCT 100-6T-5.5 IE3 | 960              | 15.60                          | 8.99  |       | 4.00                       | 52000                                       | 84                               | 102                    | 131 | 2015                | 2015 |

\* Equipment not covered by Directive 2009/125/EC



## Erp. (Energy Related Products)

Information on Directive 2009/125/EC can be downloaded from the SODECA website or the QuickFan selector programme.

## Accessories

See accessories section.

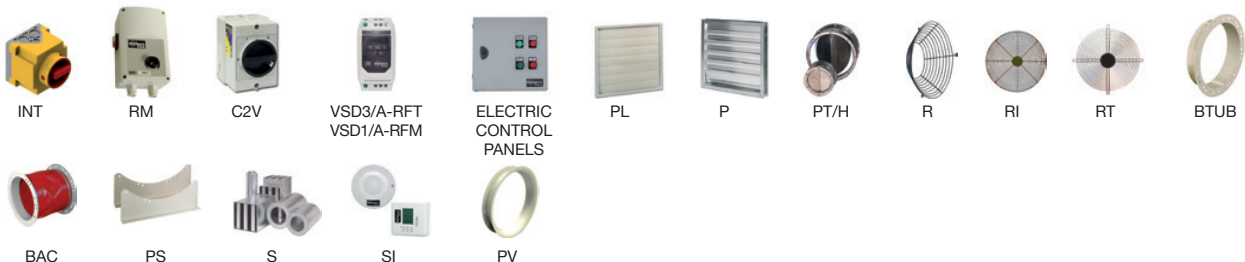

# AXIAL FANS AND ROOF-MOUNTED EXTRACT FANS

## Acoustic characteristics

The indicated values are determined by measuring the pressure and sound power levels in dB(A) obtained in a free field at a distance equivalent to twice the size of the fan plus the impeller diameter, with a minimum of 1.5 m.

Noise power spectrum Lw(A) in dB(A) frequency band in [Hz]

| Model     | 63 | 125 | 250 | 500 | 1000 | 2000 | 4000 | 8000 | Model     | 63 | 125 | 250 | 500 | 1000 | 2000 | 4000 | 8000 |
|-----------|----|-----|-----|-----|------|------|------|------|-----------|----|-----|-----|-----|------|------|------|------|
| 25-2      | 35 | 50  | 69  | 68  | 69   | 68   | 63   | 54   | 71-4-1.5  | 55 | 75  | 83  | 88  | 90   | 87   | 80   | 69   |
| 25-4      | 21 | 36  | 55  | 54  | 55   | 54   | 49   | 40   | 71-4-2    | 56 | 76  | 84  | 89  | 91   | 88   | 81   | 70   |
| 31-2      | 41 | 56  | 75  | 74  | 75   | 74   | 69   | 60   | 71-4-3    | 58 | 78  | 86  | 91  | 93   | 90   | 83   | 72   |
| 31-4      | 23 | 38  | 57  | 56  | 57   | 56   | 51   | 42   | 71-4-4    | 59 | 79  | 87  | 92  | 94   | 91   | 84   | 73   |
| 35-2      | 48 | 63  | 82  | 81  | 82   | 81   | 76   | 67   | 71-6-0.75 | 44 | 64  | 72  | 77  | 79   | 76   | 69   | 58   |
| 35-4      | 30 | 45  | 64  | 63  | 64   | 63   | 58   | 49   | 71-6-1    | 45 | 65  | 73  | 78  | 80   | 77   | 70   | 59   |
| 40-2      | 55 | 70  | 89  | 88  | 89   | 88   | 83   | 74   | 71-6-1.5  | 46 | 66  | 74  | 79  | 81   | 78   | 71   | 60   |
| 40-4      | 35 | 50  | 69  | 68  | 69   | 68   | 63   | 54   | 80-4-3    | 59 | 79  | 87  | 92  | 94   | 91   | 84   | 73   |
| 45-2-2    | 51 | 68  | 80  | 88  | 93   | 93   | 89   | 82   | 80-4-4    | 60 | 80  | 88  | 93  | 95   | 92   | 85   | 74   |
| 45-2-3    | 53 | 70  | 82  | 90  | 95   | 95   | 91   | 84   | 80-4-5.5  | 61 | 81  | 89  | 94  | 96   | 93   | 86   | 75   |
| 45-4-0.5  | 33 | 50  | 62  | 70  | 75   | 75   | 71   | 64   | 80-6-1    | 48 | 68  | 76  | 81  | 83   | 80   | 73   | 62   |
| 45-6      | 20 | 37  | 49  | 57  | 62   | 62   | 58   | 51   | 80-6-1.5  | 49 | 69  | 77  | 82  | 84   | 81   | 74   | 63   |
| 50-4      | 37 | 54  | 67  | 74  | 79   | 80   | 75   | 68   | 80-6-2    | 50 | 70  | 78  | 83  | 85   | 82   | 75   | 64   |
| 56-4-0.75 | 47 | 67  | 75  | 80  | 82   | 79   | 72   | 61   | 80-6-3    | 51 | 71  | 79  | 84  | 86   | 83   | 76   | 65   |
| 56-4-1    | 48 | 68  | 76  | 81  | 83   | 80   | 73   | 62   | 90-4-4    | 65 | 86  | 93  | 98  | 101  | 97   | 90   | 79   |
| 56-4-1.5  | 49 | 69  | 77  | 82  | 84   | 81   | 74   | 63   | 90-4-5.5  | 67 | 88  | 95  | 100 | 103  | 99   | 92   | 81   |
| 56-4-2    | 50 | 70  | 78  | 83  | 85   | 82   | 75   | 64   | 90-4-7.5  | 69 | 90  | 97  | 102 | 105  | 101  | 94   | 83   |
| 56-6-0.33 | 36 | 56  | 64  | 69  | 71   | 68   | 61   | 50   | 90-4-10   | 70 | 91  | 98  | 103 | 106  | 102  | 95   | 84   |
| 56-6-0.5  | 36 | 56  | 64  | 69  | 71   | 68   | 61   | 50   | 90-6-3    | 56 | 77  | 84  | 89  | 92   | 88   | 81   | 70   |
| 56-6-0.75 | 37 | 57  | 65  | 70  | 72   | 69   | 62   | 51   | 90-6-4    | 57 | 78  | 85  | 90  | 93   | 89   | 82   | 71   |
| 63-4-1    | 50 | 70  | 78  | 83  | 85   | 82   | 75   | 64   | 100-4-7.5 | 72 | 92  | 100 | 105 | 107  | 104  | 97   | 86   |
| 63-4-1.5  | 51 | 71  | 79  | 84  | 86   | 83   | 76   | 65   | 100-4-10  | 73 | 93  | 101 | 106 | 108  | 105  | 98   | 87   |
| 63-4-2    | 52 | 72  | 80  | 85  | 87   | 84   | 77   | 66   | 100-4-15  | 74 | 94  | 102 | 107 | 109  | 106  | 99   | 88   |
| 63-4-3    | 53 | 73  | 81  | 86  | 88   | 85   | 78   | 67   | 100-4-20  | 75 | 95  | 103 | 108 | 110  | 107  | 100  | 89   |
| 63-4-4    | 54 | 74  | 82  | 87  | 89   | 86   | 79   | 68   | 100-6-3   | 62 | 82  | 90  | 95  | 97   | 94   | 87   | 76   |
| 63-6-0.5  | 41 | 61  | 69  | 74  | 76   | 73   | 66   | 55   | 100-6-4   | 63 | 83  | 91  | 96  | 98   | 95   | 88   | 77   |
| 63-6-0.75 | 42 | 62  | 70  | 75  | 77   | 74   | 67   | 56   | 100-6-5.5 | 64 | 84  | 92  | 97  | 99   | 96   | 89   | 78   |
| 63-6-1    | 43 | 63  | 71  | 76  | 78   | 75   | 68   | 57   |           |    |     |     |     |      |      |      |      |

## Dimensions mm

HCH

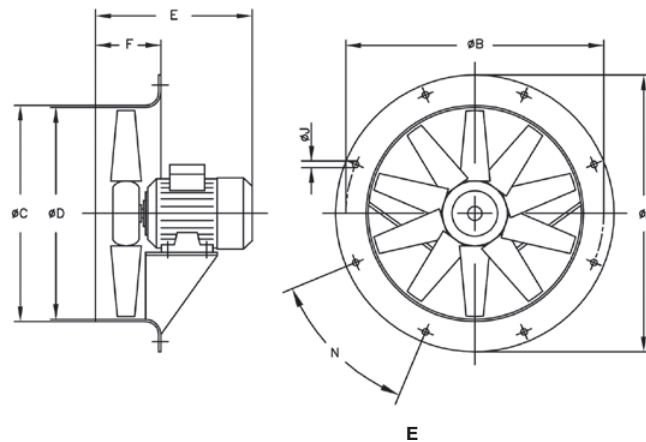

| Model     | ØA   | ØB   | ØC   | ØD   | 0.16 | 0.33 | 0.5 | 0.75 | 1   | 1.5 | 2   | 3   | 4   | 5.5 | 7.5 | 10  | 15  | 20  | F   | ØJ | N         |
|-----------|------|------|------|------|------|------|-----|------|-----|-----|-----|-----|-----|-----|-----|-----|-----|-----|-----|----|-----------|
| HCH-35-2  | 425  | 395  | 358  | 355  | -    | -    | 285 | -    | -   | -   | -   | -   | -   | -   | -   | -   | -   | -   | 110 | 10 | 8x45°     |
| HCH-35-4  | 425  | 395  | 358  | 355  | 257  | -    | -   | -    | -   | -   | -   | -   | -   | -   | -   | -   | -   | -   | 110 | 10 | 8x45°     |
| HCH-40-2  | 490  | 450  | 414  | 410  | -    | -    | -   | -    | -   | 314 | -   | -   | -   | -   | -   | -   | -   | -   | 120 | 12 | 8x45°     |
| HCH-40-4  | 490  | 450  | 414  | 410  | -    | 305  | -   | -    | -   | -   | -   | -   | -   | -   | -   | -   | -   | -   | 120 | 12 | 8x45°     |
| HCH-45-4  | 540  | 500  | 464  | 460  | -    | -    | 295 | -    | -   | -   | -   | -   | -   | -   | -   | -   | -   | -   | 120 | 12 | 8x45°     |
| HCH-45-6  | 540  | 500  | 464  | 460  | -    | 295  | -   | -    | -   | -   | -   | -   | -   | -   | -   | -   | -   | -   | 120 | 12 | 8x45°     |
| HCH-56-4  | 660  | 620  | 564  | 560  | -    | -    | -   | 316  | 316 | 330 | 354 | -   | -   | -   | -   | -   | -   | -   | 120 | 12 | 12x30°    |
| HCH-56-6  | 660  | 620  | 564  | 560  | -    | 298  | 316 | 316  | -   | -   | -   | -   | -   | -   | -   | -   | -   | -   | 120 | 12 | 12x30°    |
| HCH-63-4  | 730  | 690  | 645  | 640  | -    | -    | -   | -    | 332 | 340 | 366 | 420 | 420 | -   | -   | -   | -   | -   | 150 | 12 | 12x30°    |
| HCH-63-6  | 730  | 690  | 645  | 640  | -    | -    | 332 | 332  | 340 | -   | -   | -   | -   | -   | -   | -   | -   | -   | 150 | 12 | 12x30°    |
| HCH-71-4  | 810  | 770  | 715  | 710  | -    | -    | -   | -    | -   | 334 | 360 | 430 | 430 | -   | -   | -   | -   | -   | 150 | 12 | 16x22°30' |
| HCH-71-6  | 810  | 770  | 715  | 710  | -    | -    | -   | 323  | 334 | 360 | -   | -   | -   | -   | -   | -   | -   | -   | 150 | 12 | 16x22°30' |
| HCH-80-4  | 900  | 860  | 805  | 800  | -    | -    | -   | -    | -   | -   | 425 | 425 | 445 | -   | -   | -   | -   | -   | 180 | 12 | 16x22°30' |
| HCH-80-6  | 900  | 860  | 805  | 800  | -    | -    | -   | -    | 360 | 386 | 425 | 445 | -   | -   | -   | -   | -   | -   | 180 | 12 | 16x22°30' |
| HCH-90-4  | 1015 | 970  | 906  | 900  | -    | -    | -   | -    | -   | -   | -   | 436 | 430 | 465 | 465 | -   | -   | -   | 180 | 12 | 16x22°30' |
| HCH-90-6  | 1015 | 970  | 906  | 900  | -    | -    | -   | -    | -   | -   | 436 | 430 | 465 | -   | -   | -   | -   | -   | 180 | 12 | 16x22°30' |
| HCH-100-4 | 1115 | 1070 | 1006 | 1000 | -    | -    | -   | -    | -   | -   | -   | -   | -   | -   | 503 | 503 | 612 | 612 | 200 | 15 | 16x22°30' |
| HCH-100-6 | 1115 | 1070 | 1006 | 1000 | -    | -    | -   | -    | -   | -   | 440 | 503 | 503 | -   | -   | -   | -   | -   | 200 | 15 | 16x22°30' |

## Dimensions mm

### HCT

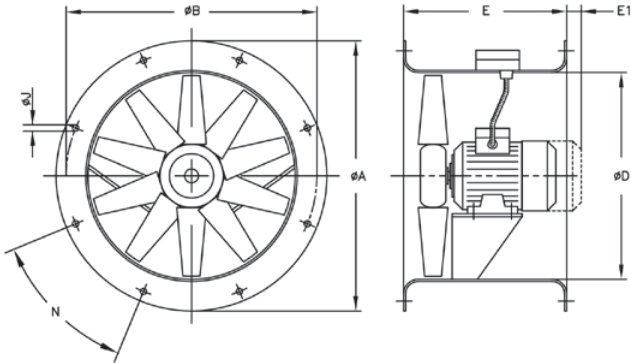

| Model         | ØA   | ØB   | ØD   | E   | E1 | ØJ | N         |
|---------------|------|------|------|-----|----|----|-----------|
| HCT-25        | 310  | 280  | 240  | 230 | 10 | 10 | 4x90°     |
| HCT-31        | 350  | 320  | 280  | 270 | -  | 10 | 4x90°     |
| HCT-35        | 425  | 395  | 355  | 280 | -  | 10 | 8x45°     |
| HCT-40        | 490  | 450  | 410  | 320 | -  | 12 | 8x45°     |
| HCT-45        | 540  | 500  | 460  | 360 | -  | 12 | 8x45°     |
| HCT-50        | 600  | 560  | 514  | 360 | -  | 12 | 12x30°    |
| HCT-56        | 660  | 620  | 560  | 400 | -  | 12 | 12x30°    |
| HCT-63        | 730  | 690  | 640  | 430 | -  | 12 | 12x30°    |
| HCT-71        | 810  | 770  | 710  | 500 | -  | 12 | 16x22°30' |
| HCT-80        | 900  | 860  | 800  | 500 | -  | 12 | 16x22°30' |
| HCT-90        | 1015 | 970  | 900  | 500 | -  | 15 | 16x22°30' |
| HCT-100       | 1115 | 1070 | 1000 | 600 | -  | 15 | 16x22°30' |
| HCT-100-4T-15 | 1115 | 1070 | 1000 | 700 | -  | 15 | 16x22°30' |
| HCT-100-4T-20 | 1115 | 1070 | 1000 | 700 | -  | 15 | 16x22°30' |

## Characteristic curves

Q= Flow rate in m<sup>3</sup>/h, m<sup>3</sup>/s and cfm.

Pe= Static pressure in mm H<sub>2</sub>O, Pa and inwg.

2-Pole=3000 r/min

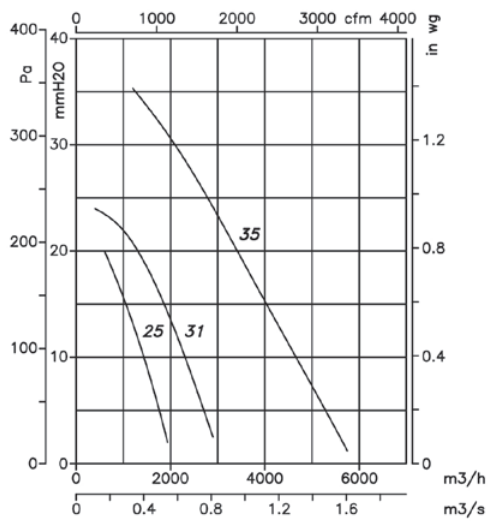

2-Pole=3000 r/min

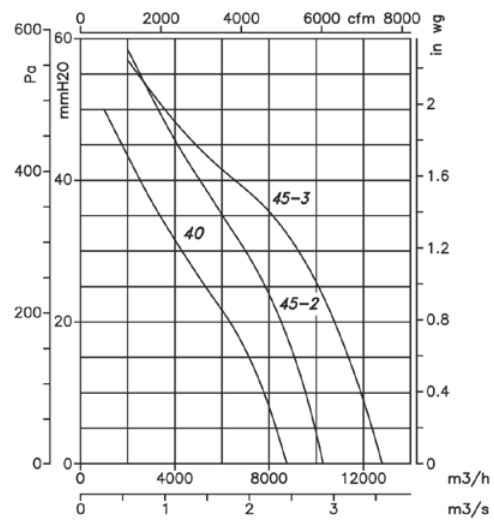

4-Pole=1500 r/min

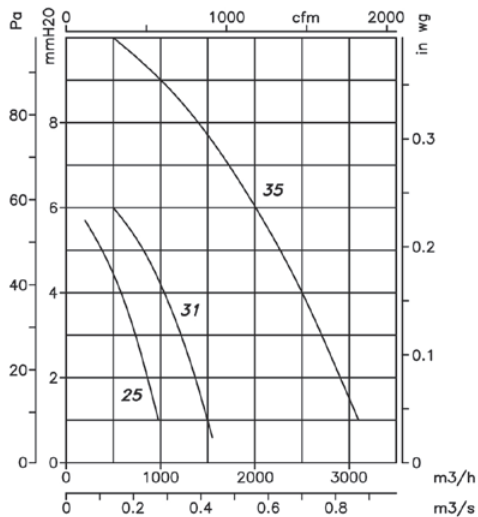

4-Pole=1500 r/min

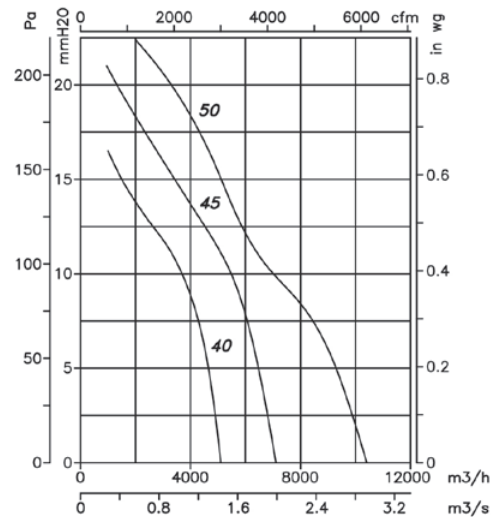

# AXIAL FANS AND ROOF-MOUNTED EXTRACT FANS

## Characteristic curves

Q= Flow rate in m<sup>3</sup>/h, m<sup>3</sup>/s and cfm.

Pe= Static pressure in mm H<sub>2</sub>O, Pa and inwg.

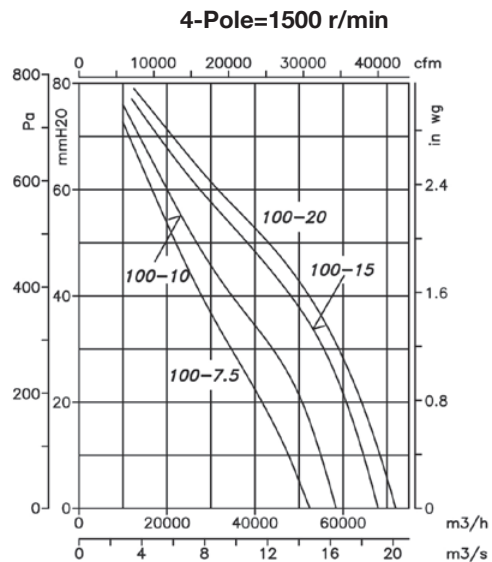
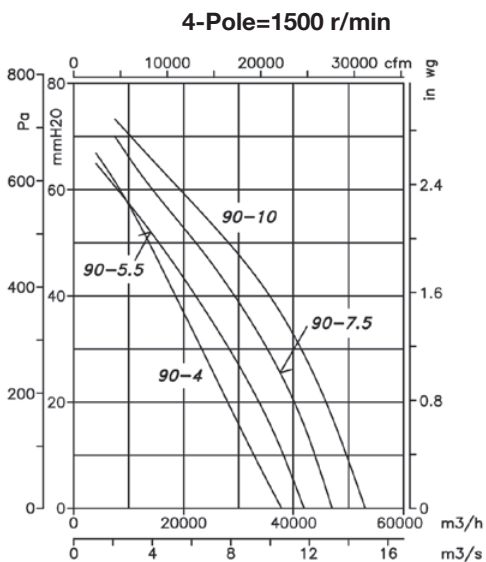
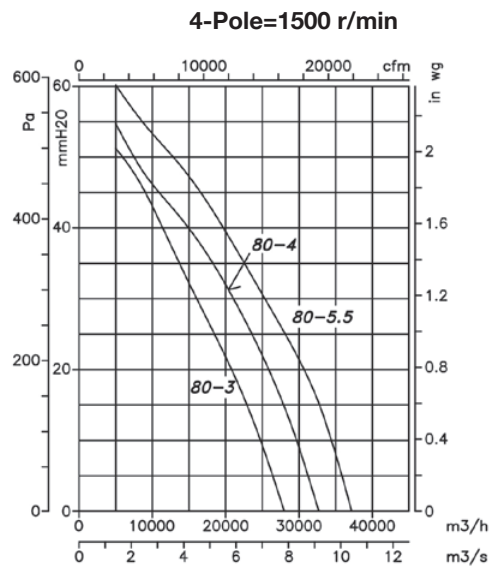
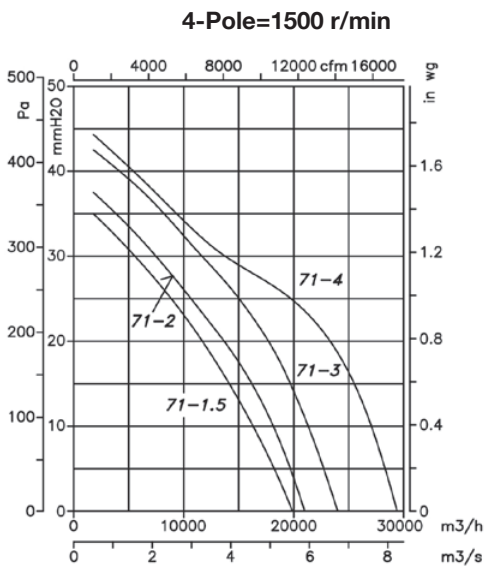
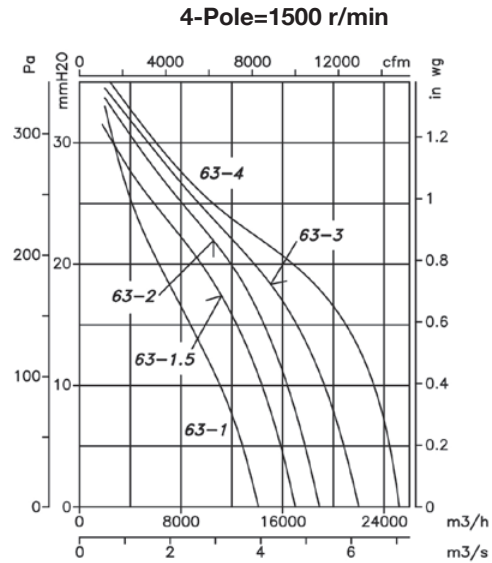
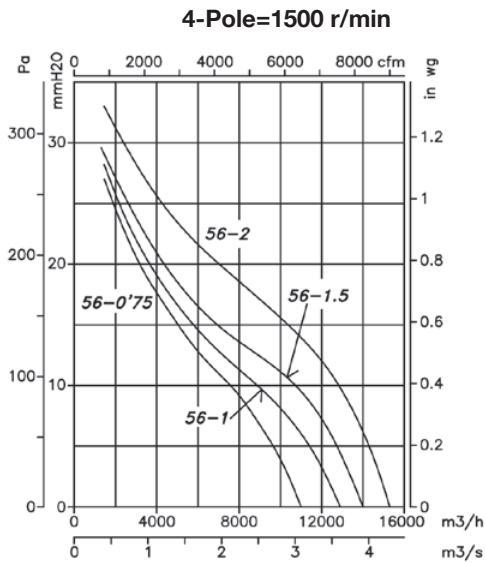

### Characteristic curves

Q= Flow rate in m<sup>3</sup>/h, m<sup>3</sup>/s and cfm.

Pe= Static pressure in mm H<sub>2</sub>O, Pa and inwg.

