

# CA/LINE



*In-line circular duct extractor fans with 3-speed motors.*



**Fan:**

- Sheet steel casing.
- External terminal box.
- Easy, rapid installation.
- Support foot included.

**Finish:**

- Anti-corrosive finish on galvanised sheet steel.

**Motor:**

- 3-speed motors with long-life ball bearings and IP44 protection.
- Single-phase 220-240 V 50/60 Hz.
- Operating temperature -25 °C +60 °C.

## Order code

**CA/LINE — 20**

CA/LINE: Circular in line duct extractor fans with 3-speed motors

Nozzle diameter in mm

## Technical characteristics

	Speed Max/min (r/min)	Maximum admissible current (A) 230 V	Max. electric power (W)	Maximum flow rate (m <sup>3</sup> /h)	Irradiated sound pressure level (dBA)	Approx. weight (kg)	According to ErP
CA/LINE-10	2700 / 2100	0.24	53	250	43	2.8	2018
CA/LINE-12	2650 / 2050	0.23	52	320	40	2.8	2018
CA/LINE-15	2650 / 2000	0.24	55	470	37	4.8	2018
CA/LINE-16	2650 / 2000	0.24	55	490	36	4.8	2018
CA/LINE-20	2700 / 2450	0.45	110	870	43	6.2	2018
CA/LINE-25	2400 / 1600	0.70	165	1070	47	6.6	2018
CA/LINE-31	2500 / 2300	0.64	150	1310	46	6.9	2018



## Erp. (Energy Related Products)

Information on Directive 2009/125/EC can be downloaded from the SODECA website or the QuickFan selector programme.

## Acoustic characteristics

Sound power spectrum L<sub>w</sub>(A) in dB(A) per Hz frequency band

Irradiated values at maximum speed and 2/3 of max. flow rate

	63	125	250	500	1000	2000	4000	8000
CA/LINE-10	39	38	44	44	52	48	50	35
CA/LINE-12	37	31	38	43	47	47	46	42
CA/LINE-15	31	32	38	43	46	44	33	28
CA/LINE-16	31	35	37	35	45	41	39	31
CA/LINE-20	39	34	50	49	48	46	44	36
CA/LINE-25	35	40	42	51	53	57	49	37
CA/LINE-31	36	47	50	51	51	51	51	38

# CENTRIFUGAL FANS AND IN-LINE DUCT EXTRACTOR FANS

## Dimensions mm

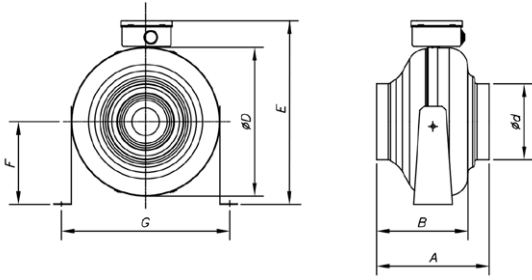

	A	B	ød	øD	E	F	G
CA/LINE-10	202	177	98	237	294	130	270
CA/LINE-12	202	177	123	237	294	130	270
CA/LINE-15	200	175	148	278	323	167	312
CA/LINE-16	200	175	158	278	351	167	312
CA/LINE-20	242	215	199	333	402	190	374
CA/LINE-25	215	184	250	333	402	190	374
CA/LINE-31	276	248	313	402	472	225	443

## Characteristic curves

Q= Flow rate in m<sup>3</sup>/h, m<sup>3</sup>/s and cfm

Pe= Static pressure in mmH<sub>2</sub>O, Pa and inwg

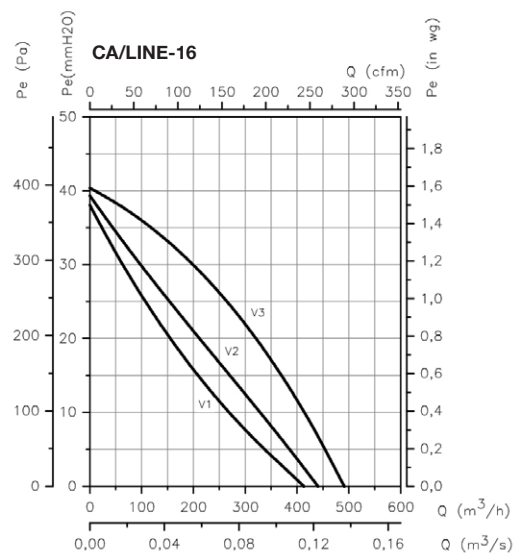
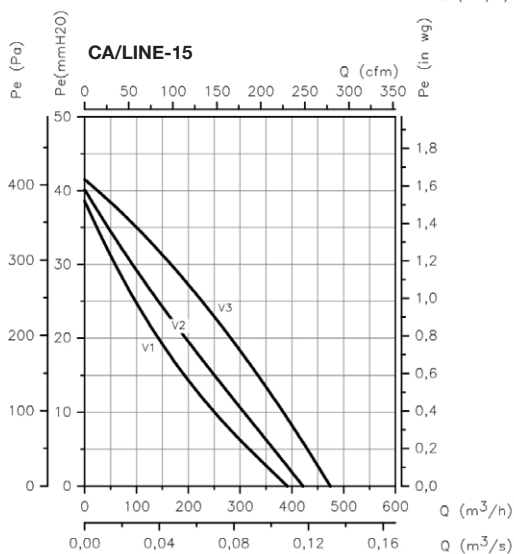
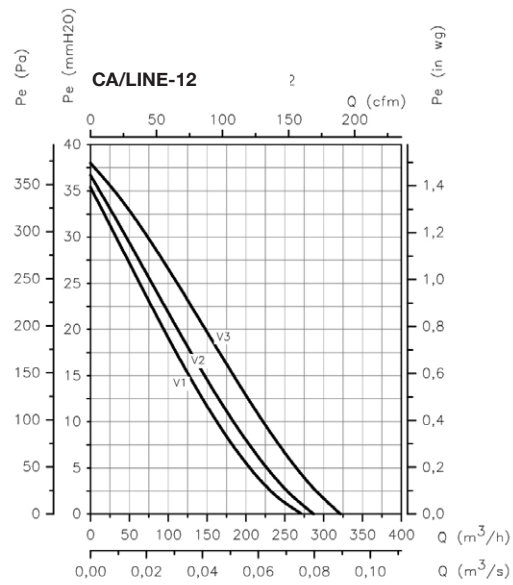
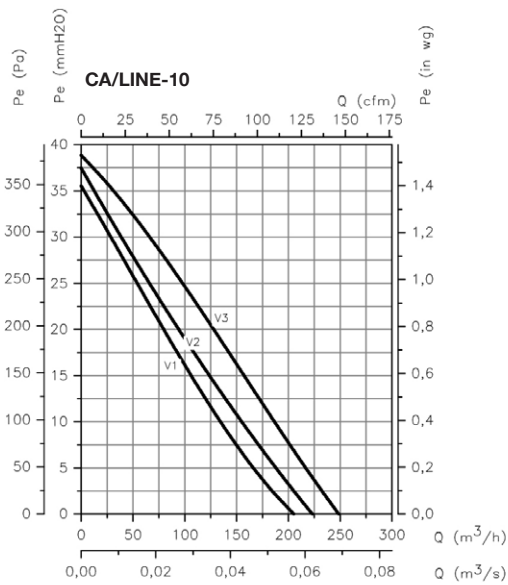

## Characteristic curves

Q= Flow rate in m<sup>3</sup>/h, m<sup>3</sup>/s and cfm

Pe= Static pressure in mmH<sup>2</sup>O, Pa and inwg

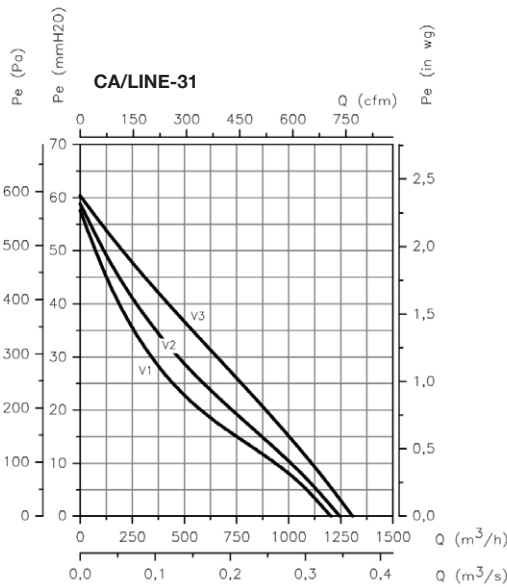
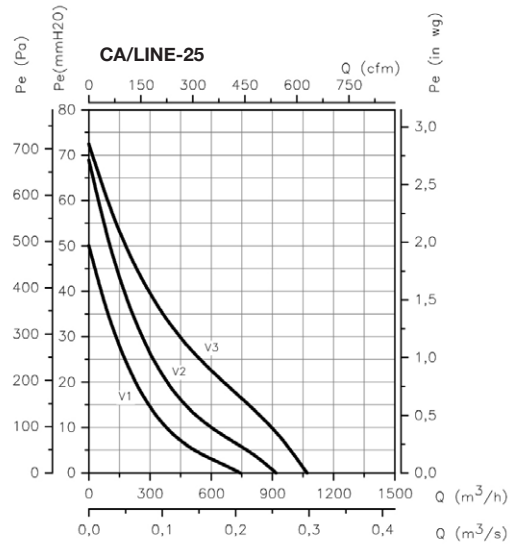
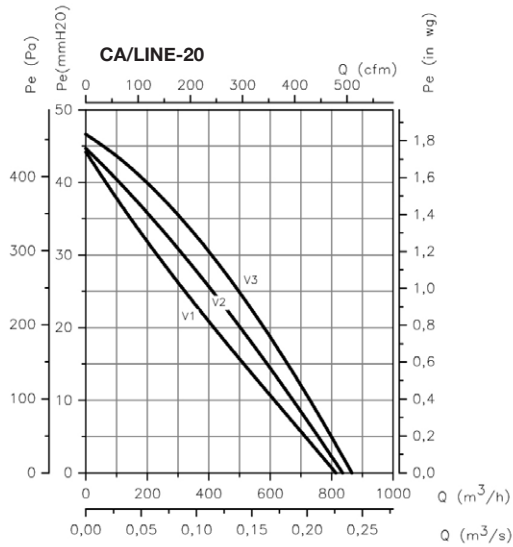

## Recommended accessories



SI-VOC+HUMIDITY 3V	-	CA/LINE
--------------------	---	---------

Accessories recommended to comply with ErP 2018