

CKD

F400 extractor fan units with a large door for ease of maintenance and 40 mm acoustic insulation slab



Fan:

- Galvanised sheet steel structure.
- 40 mm acoustic insulation.
- Forward curved impeller in galvanised sheet steel.
- Approved in accordance with standard EN 12101-3, with certificate no.: 0370-CPR-2358.
- Changeable opening door direction thanks to its interchangeable hinges.
- Adjustable in different positions.
- Prepared for continuous work at 120 °C.
- Motor cover accessory (CM) supplied with fan.

Motor:

- Motors with IE3 efficiency for powers equal to or greater than 0.75 kW, except single-phase, 2-speed and 8-pole.
- Class F motors with ball bearings and IP55 protection.
- Single-phase 230 V 50 Hz and three-phase 230/400 V 50 Hz.
- Working temperature: -25 °C +120 °C.

Finish:

- Anti-corrosive in galvanised steel sheet.

On request:

- Special windings for different voltages.

Order code

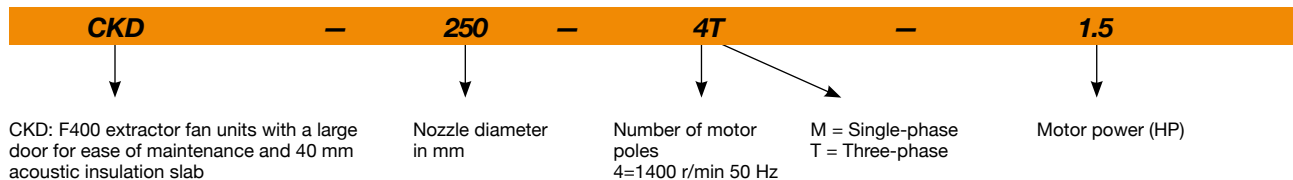

Technical characteristics

Model	Speed (r/min)	Maximum admissible current (A)		Installed power (kW)	Maximum flow rate (m ³ /h)	Sound pressure level dB (A)	Approx. weight (Kg)
		230V	400V				
CKD-250-4T-1.5 IE3	1455	4.07	2.34	1.1	3160	69	48
CKD-280-4T-3 IE3	1435	7.93	4.56	2.2	4880	73	60



Erp. (Energy Related Products)

Information on Directive 2009/125/EC can be downloaded from the SODECA website or the QuickFan selector programme.

Acoustic characteristics

The indicated values are determined by measuring the sound pressure level and sound power in dB(A) obtained in a free field at a distance equivalent to twice the size of the fan plus the impeller diameter, with a minimum of 1.5 m.

Sound power spectrum Lw(A) in dB(A) per Hz frequency band

	63	125	250	500	1000	2000	4000	8000
CKD-250-4	53	79	74	73	66	67	60	60
CKD-280-4	53	82	78	76	70	71	63	63

Dimensions mm

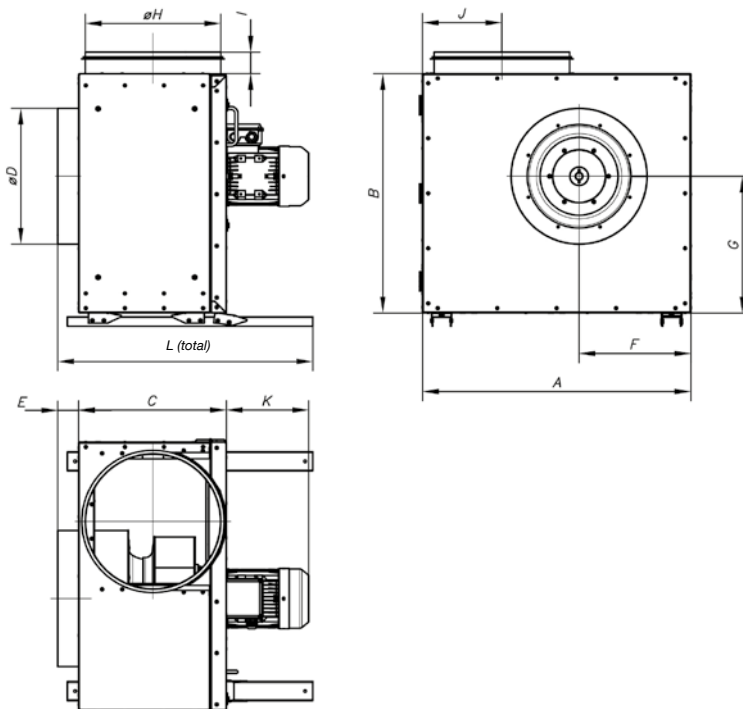

	A	B	C	$\varnothing D$	E	F	G	$\varnothing H$	I	J	K	L
CKD-250	590	520	260	250	50	245	290	250	48	160	225	560
CKD-280	590	520	275	315	50	245	290	250	48	160	287	600

Accessories



INT



RM



VSD3/A-RFT
- VSD1/A-RFM

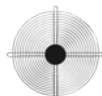

RT



BTUB



PT



ACE ACE/400

Characteristic curves

Q= Flow rate in m³/h, m³/s and cfm

Pe= Static pressure in mm H₂O, Pa and inwg

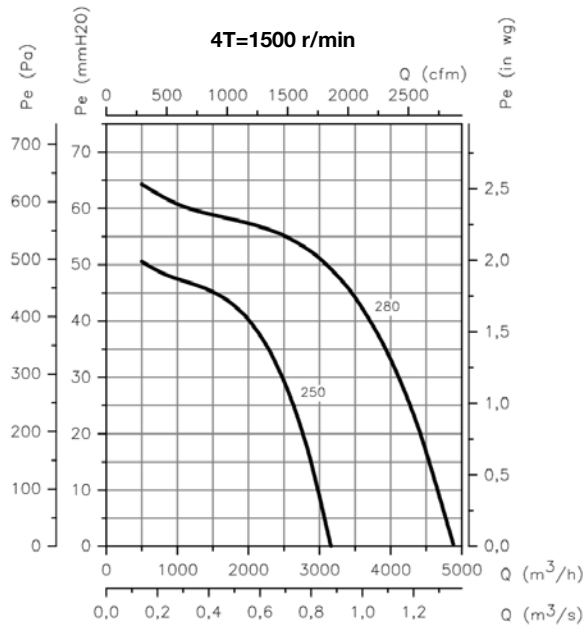

Orientations

Standard supply: LG 0

On request orientations LG 90 and LG 270. Different mounting positions are possible by modifying the feet and interchangeable hinges, depending on each need.

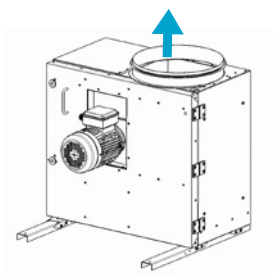

LG 0

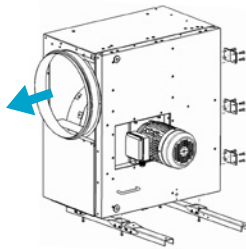

LG 90

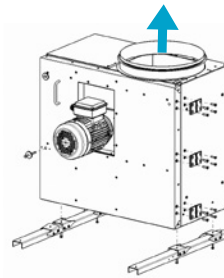

LG 0

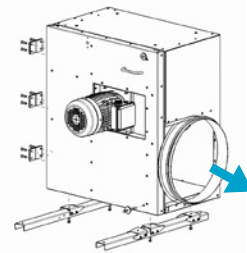

LG 270

Installation

The CKD/CKDR fans can be wall-mounted using angle brackets.

